

Vaporetto *Lecoaspira* 690

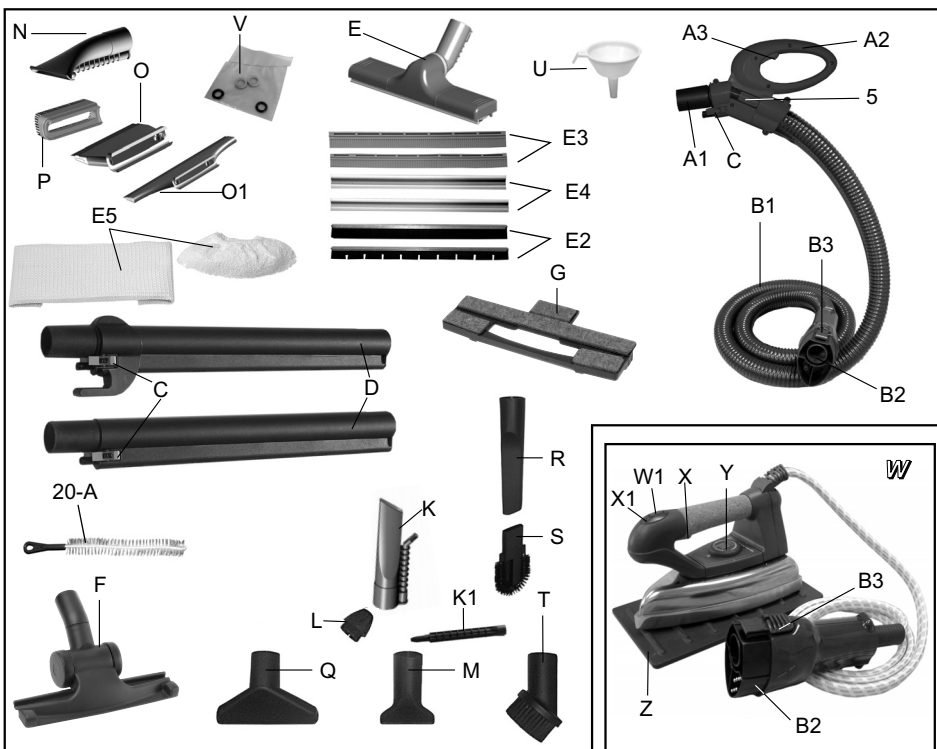

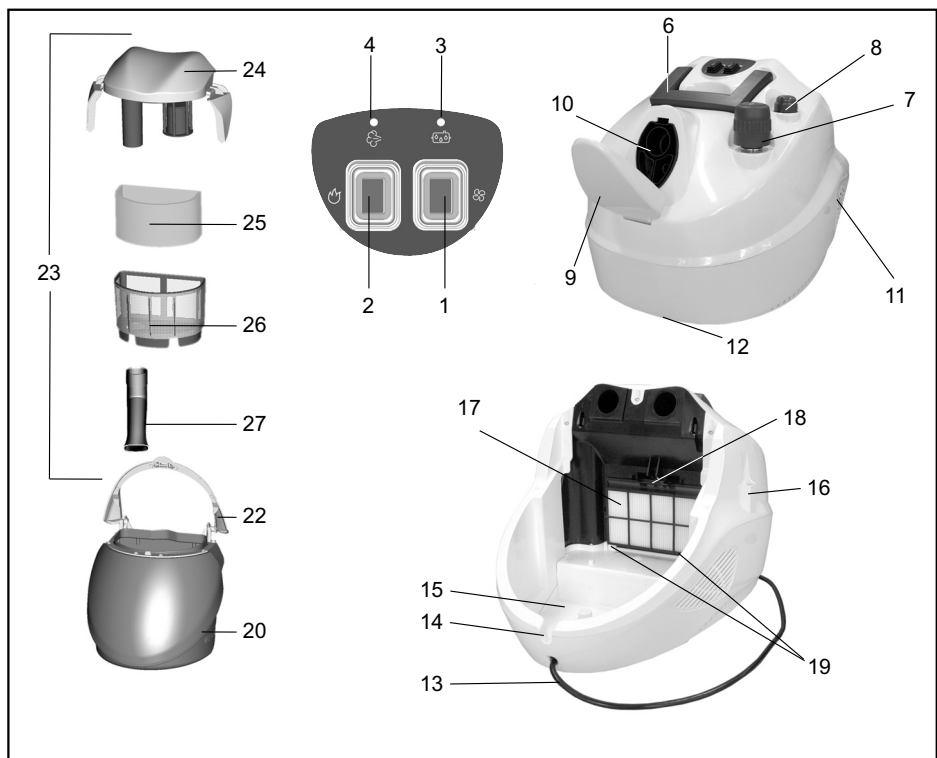

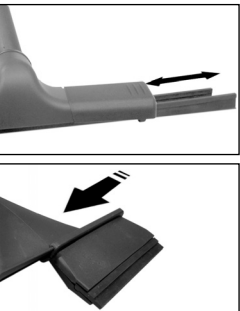

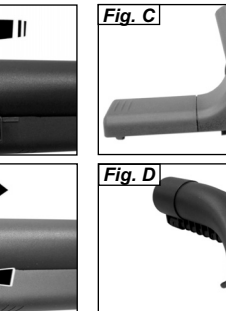
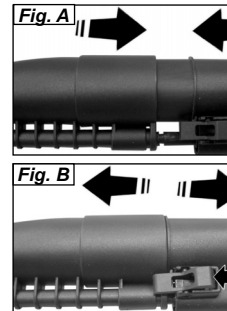
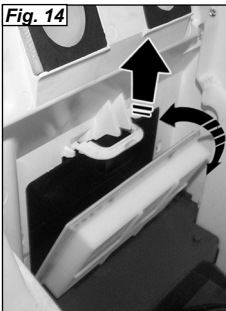
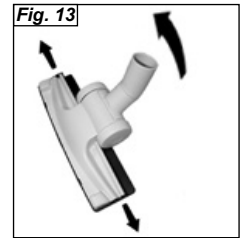
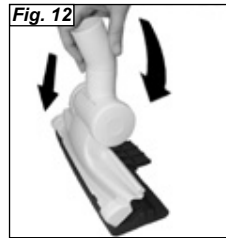
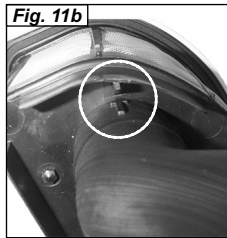
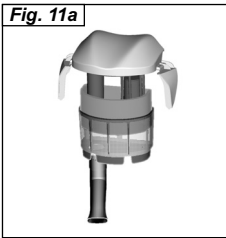
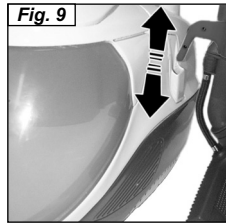
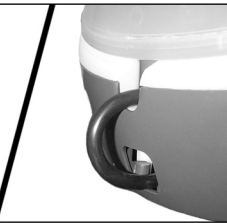
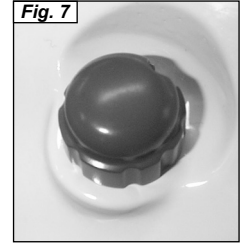
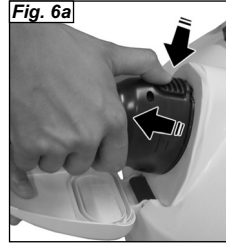
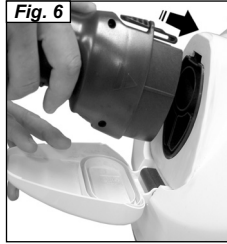
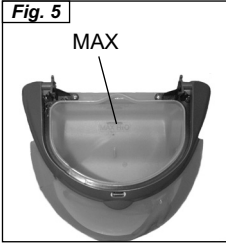
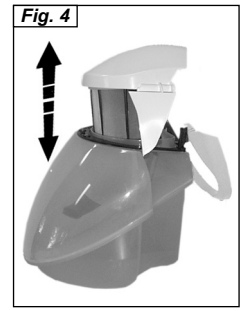
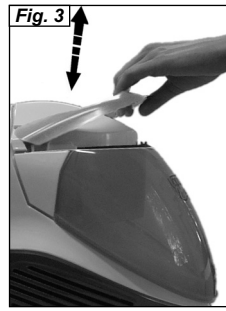
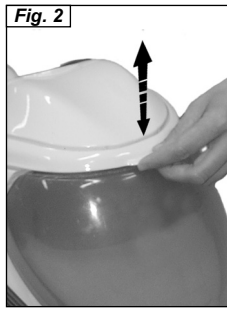

Read these instructions carefully before using the appliance.

KEY

- 1) Suction switch
- 2) Boiler switch
- 3) "Out of water" indicator light
- 4) Pressure indicator light
- 5) Suction regulator
- 6) Carrying handle
- 7) Safety cap
- 8) Steam control knob
- 9) Hose connection flap
- 10) Hose connection
- 11) Air outlet grill
- 12) Pivoting wheels
- 13) Power supply cable
- 14) Supply cable channel
- 15) Supply cable storage
- 16) Accessories holder
- 17) Hepa filter
- 18) Unhooking lever for Hepa filter
- 19) Hepa filter holders
- 20) Dirt container
- 21) MAX level (fig. 5)
- 22) Dirt container handle
- 23) "EcoActive Filter" water filter assembly
- 24) EcoActive Filter" water filter assembly cover
- 25) Shaped filtering sponge
- 26) Filter body with microhole net
- 27) Elbow tube

KEY TO ACCESSORIES

- A1) Fitting for accessories connection
- A2) Handle
- A3) Steam button
- B1) Steam+suction hose
- B2) Monobloc plug
- B3) Locking button of the monobloc plug
 - C) Accessories locking button
 - D) Steam + suction extension tubes
 - E) Universal brush
- E2) Bristle inserts
- E3) Liquid suction inserts
- E4) Insert for fitted carpet

- E5) Cotton cloths
- K) 120° steam-suction accessory
- L) Small coloured 120° steam-suction brushes
- N) Small steam-suction upholstery nozzle
- O1) Squeegee attachment for small steam-suction upholstery nozzle (200 mm)
- P) Bristle attachment for small steam-suction upholstery nozzle
- U) Filler funnel
- V) Spare gaskets
- 20-A) Dirt container cleaning brush

OPTIONAL ACCESSORIES

- F) Joker brush
- G) Parquet accessory
- K1) Steam lance
- M) Small steam-suction nozzle
- O) Squeegee attachment for small steam-suction upholstery nozzle (130 mm)
- Q) Upholstery nozzle
- R) Lance
- S) Radiator brush
- T) Suction brush
- W) Iron
- W1) Continuous steam button
- X) Steam request button
- X1) "Iron heating" indicator light
- Y) Temperature control dial
- Z) Iron rest mat

Dear Customer,

We wish to thank you for placing your trust in us and choosing a Polti product.

In choosing your Vaporetto Lecoaspira, you were thinking of the hygiene of your home and of the health of your family, because Vaporetto Lecoaspira allows you to clean most surfaces with the pure power that steam provides. It dissolves and collects dirt and traps dust-mites and allergens in the water.

Thanks to the unique EcoActive-Filter, after vacuuming you can pour away the dirty water without the risk of spreading dust everywhere.

The air-filtering system is completed by the air outlet filter, which retains the fine particles, so that the output air is thoroughly cleaned.

With Vaporetto Lecoaspira you will be able to use steam and suction together for a complete clean, suction alone so as to collect all the dust efficiently, or steam alone for specific cleaning tasks.

We strongly recommend reading this instruction book carefully before using Vaporetto Lecoaspira.

What is EcoActive-Filter?

EcoActive-Filter is a revolutionary water filter patented by Polti. EcoActive-Filter uses the natural purifying property of water to capture the dirt, thus avoiding unpleasant contact with the dust and its harmful dispersion into the environment. It is precisely the flow of water contained in the special filter and its bubbling that make cleaning done with Vaporetto Lecoaspira so efficient.



This unit conforms with EC-directives 2004/108/CE (EMC) and 2006/95/CE (low voltage).

Politi S.p.A. reserves the right to change equipment or accessory specification without prior notice.

PRECAUTIONS**KEEP THESE INSTRUCTIONS**

- Read these instructions for use carefully before using the appliance, and make sure that anyone using the machine is familiar with these instructions and the warnings.
- **DO NOT USE THE STEAM FUNCTION ON DRAYLON, VELVET, LEATHER OR OTHER SENSITIVE FABRICS.**
- Any use which does not comply with these instructions will invalidate the warranty.
- The wiring system to which the appliance is connected must always comply with the laws in force.
- Before connecting the appliance, make sure that the mains voltage is the same as the voltage indicated on the data label of the appliance and that the power outlet is connected to earth
- Always turn off the appliance at the on/off switch before unplugging it.
- If the appliance is left unused, always disconnect it from the mains. Never leave the appliance unattended with the cable plugged into the mains.
- Always make sure the appliance is unplugged before performing maintenance work of any kind
- Do not pull the power cable out of the socket, but grasp the plug itself to avoid damage to the socket.
- Do not allow the power cable to be twisted, crushed, stretched, or come into contact with sharp or hot surfaces.
- Do not use the appliance if the power cable or other important parts are damaged.
- Do not use electric extension leads that are not authorized by the manufacturer, as they may cause damage or fire.
- If it is necessary to replace the power supply cable, please refer to the nearest Polti authorised service centre, since the use of a special tool is necessary.
- Never touch the appliance with wet hands or feet with the cable plugged into the mains.
- Do not use the appliance when barefoot.
- Do not use the appliance near a bathtub, shower or container full of water
- Never immerse the appliance, the cable or the plugs in water or another liquid.
- Use of the appliance in places where there is a danger of explosions is prohibited.
- Do not use the product with toxic substances.
- Do not lay the hot appliance on surfaces sensitive to heat.
- Do not leave the appliance exposed to wind or rain.
- Do not place the appliance near a live element, an electric stove or any other source of heat.
- Do not expose the appliance to extreme temperatures
- Never let children or people who are not familiar with how the appliance works use it.
- Do not press the buttons hard or with a pointed object such as a pen.
- Always rest the appliance on a stable surface.
- If the appliance is dropped and shows signs of damage, do not use it but take it to a technical service centre.
- In case of breakdown or malfunction switch off the appliance and never attempt to disassemble it, but refer to an authorized Service Centre.
- To avoid prejudicing the safety of the appliance, use only original spare parts and accessories approved by the manufacturer.
- Do not wind the power cable around the appliance, especially when the appliance is still hot.
- Do not use the appliance to suck up acids or solvents, as these might cause serious damage to the appliance and above all do not suck up explosive dust or liquids, as these could cause explosions on coming into contact with the inside components of the appliance.
- Do not suck up toxic substances.
- Do not suck up burning or incandescent objects like embers, ash or other material in which combustion is taking place.
- Do not vacuum up detergents or other

substances which could generate foam inside the Dirt container, as this could cause malfunctioning.

- Dirt container can be filled with tap water.
- Do not suck up materials such as cement, chalk etc. which solidify once they come in contact with water thus damaging the appliance
- During refilling with water, switch off and disconnect the appliance from the mains.
- It is necessary to keep the unit in horizontal position during operation.
- Do not direct the steam jet onto electrical and/or electronic appliances.
- Let the appliance cool down before cleaning it.
- Before storing the appliance make sure that it has completely cooled down.
- This appliance is equipped with safety devices which are to be replaced only by a suitably qualified technician.
- Do not direct the steam jet at people, animals or debris.
- Never place your hands inside the jet of steam.



ATTENTION:
Danger of burns!

- Do not put any detergent or chemical substance in the boiler. Water by its nature contains magnesium, mineral salts and other deposits which in hard water areas can contribute to limescale build-up in the boiler. To avoid these problems, it is necessary to swill out with tapwater and empty the generator boiler after every 3 or 4 uses. In hard water areas we recommend the use of KALSTOP, a special natural-base decalcifier which inhibits and breaks down limescale, making it easy to remove just by swilling out the boiler with a little tapwater. This is a preventive against lime scale build-up and protects the metal walls of the boiler. KALSTOP is available from Polti dealers or by mail-order from your Polti Service Centre.
- **We recommend only using original Polti**

products as other products may not be suitable for use with Polti appliances and may cause serious damage.

- **Never use distilled water or scented water.**
- Do not try to unscrew the safety cap or empty the appliance whilst water in the boiler is still hot.
- Do not refill the boiler while it is still hot. Allow it to cool for a good few minutes before refilling.
- When REFILLING the generator boiler, use **HOT**, not cold water. Pour in gradually and gently at first and keep your face and other exposed skin well away. Otherwise the still hot boiler walls may spit drops of very hot water or steam spray.
- Make sure the patented safety cap is fully and correctly screwed on, otherwise you may experience steam escaping from around the cap.
- Check periodically the safety cap and **MAKE SURE** the rubber gasket is in place around the base of the screw thread. Replace with original spare parts if necessary. **DO NOT USE STEAM FUNCTION** if the rubber gasket is not in position.
- If you iron sitting down, do not place your legs under the ironing board, the steam can cause burns.
- Iron only on heat resistant surfaces and on surfaces that allow the steam to escape e.g. MESH ironing boards.
- For iron rest mat replacement use only original spare parts.
- Check that the steam request button is switched off before connecting the appliance to the mains.
- This appliance is not intended for use by persons (including children) with reduced physical, sensory or mental capabilities, or lack of experience and knowledge, unless they have been given supervision or instruction concerning use of the appliance by a person responsible for their safety.
- Children should be supervised to ensure that they do not play with the appliance.
- The appliance must not be used if it has

fallen, been dropped or when it has visible signs of damage or leaks.

- The electric cable (Y type power cord) must not be replaced by the user. The cord must always be replaced by a qualified technician from one of our authorised service centres.

CORRECT USE OF THE PRODUCT

This appliance is intended for home use as a steam generator and for sucking liquids and solids as described and in accordance with the instructions provided in this manual. Please read these instructions carefully and keep them, as you may find them useful in future.

Polti declines liability for any damage or accident derived from any use of the appliance which is not in conformity with the instructions contained in this booklet

ATTENTION

Directive 2002/96/EC (Waste Electrical and Electronic Equipment - WEEE): information for users

This product complies with EU Directive 2002/96/EC.



The crossed-out wastebasket symbol on the appliance means that at the end of its useful lifespan, the product must be disposed of separately from ordinary household wastes.

The user is responsible for delivering the appliance to an appropriate collection facility at the end of its useful lifespan.

Appropriate separate collection to permit recycling, treatment and environmentally compatible disposal helps to prevent negative impact on the environment and human health and promotes the recycling of the materials making up the product. For more information on available collection facilities, contact your local waste collection service or the shop where you bought this appliance.

PREPARATION FOR USE

- Unscrew the patented safety cap (7) (Fig.1) and fill the boiler with not more than 1.3 litres of water, using the filler funnel (U). Make sure that the water does not overflow, and that space is left in the boiler for the steam to form.
- Normal tapwater can be used. Water by its nature contains magnesium, mineral salts and other deposits which in hard water areas can cause limescale build up in the boiler. It is essential to swill it out with tapwater every 3 or 4 uses. In hardwater areas, we recommend with every 3-4 uses you add **ONLY IN THE BOILER** our KALSTOP, a special natural-base decalcifier which inhibits and breaks down limescale. This is a preventive against limescale build-up and protects the metal walls of the boiler. KALSTOP is available from Polti dealers or by mail-order from your Polti Service Centre.
- **We recommend only using original Polti products as other products may not be suitable for use with Polti appliances and may cause serious damage.**
- **Never use distilled water or scented water.**
- MAKE SURE the rubber gasket is present inside the safety cap, then screw on the safety cap (7) to hand tight. Make sure the patented safety cap is fully and correctly screwed on, otherwise you may experience steam escaping around the cap.
- Lift the Dirt container handle (22) unhooking it from its position (Fig. 2) and remove the container (20) (Fig. 3).
- Turn the container handle (22) as shown in figure 4, so as to remove the "Eco ActiveFilter" water filter assembly (23).
- Fill the Dirt container (20) with about 1,2 litres of tap water until the MAX level indicator (21) is reached, as in fig. 5.
- Put the filter assembly (23) back into place in the Dirt container (20) returning it to its initial position.
- Replace the Dirt container into position.
- Support the handle (22) until it hooks into its place on the Dirt container (20).

WARNING: Do NOT under any circumstances put or leave the filler bottle in the water filling aperture of the appliance when the appliance is connected to the mains electricity supply. Danger of burns!

OPERATION

- Open the hose connection flap (9); fit the monobloc plug (B2) by pushing it, without pressing the button, until you hear the click of the locking mechanism, then make sure it is well locked (fig.6).
- To disconnect the monobloc plug (B2) from the appliance, push the button (B3) and pull the monobloc so as to separate it from the appliance (fig.6a).
- Now connect the appliance to the mains.

SUCTION ONLY MODE

- Press suction switch (1). The appliance will begin to suck.
- To stop suction, simply press suction switch again (1)
- Using the suction regulator (5) it is possible to change the suction power according to the type of cleaning required, or to stop suction immediately in case of accidental suction (e.g. curtains). It is advisable to work with the suction regulator open on curtains, carpets, and sofas, etc. Move the suction regulator forward until the hole on the handle is visible. To return to maximum power, move the suction regulator backward, gradually covering the hole.

STEAM ONLY MODE

- Press the boiler switch (2) which will light up.
- Wait for the pressure indicator light (4) goes out. When it does, Lecoaspira is ready to generate steam.
- You may now deliver steam by pressing the steam button (A3) on the handle.
- If you decide not to use the steam any longer, you may switch off the boiler by pressing the boiler switch (2).

STEAM + SUCTION MODE

You can use the steam and suction modes together by activating both as described above.

LACK OF WATER IN THE BOILER

Lack of water in the boiler will be shown by the indicator light (3). In order to continue working, proceed as described in the section "PATENTED SAFETY CAP".

PATENTED SAFETY CAP

This appliance is equipped with a patented safety cap, which prevents opening of the boiler as long as there is any pressure remaining inside. This is an important and indispensable safety device and it is necessary to follow certain procedures when re-filling the tank. When you have used up all the water in the tank, proceed as follows:

- Switch off the machine at the boiler switch (2).
- Disconnect the power supply cable (13) from the mains.
- Unscrew the safety cap (7) anti-clockwise.
- Wait for a good few minutes to allow the boiler to cool down.
- When the boiler is cool, proceed to carefully refill it as described in the paragraph headed PREPARATION FOR USE.

WARNING: When REFILLING the boiler always pour gradually into it only very small quantities at first of HOT, not cold water, so as to avoid spitting. KEEP FACE AND EXPOSED SKIN WELL AWAY FROM THE APERTURE.

REGULATION OF THE STEAM FLOW

You can optimise the steam flow by means of the control knob (8) (Fig. 7).

To obtain a higher flow rate turn the knob in a clockwise direction. When the knob is turned in an anti-clockwise direction, the flow rate decreases.

High flow rate of steam: to remove caked dirt, stains, grease and to sanitise;

Normal flow rate of steam: for wall-to-wall and loose carpeting, windows, floors;

Low flow rate of steam: for spraying plants, cleaning delicate fabrics, wallpaper.

SUPPLY CABLE STORAGE

Before putting away Vaporetto Lecoaspira, store the supply cable (13) in its compartment (15) proceeding as follows:

- Take out the Dirt container (20) as indicated in the paragraph “preparation for use”.
- Manually wind the cable evenly and put it in the storage (15), making it go through the power supply cable channel (14) (Fig.8).
- Put the Dirt container (20) back in its place making sure it is correctly positioned.

USE OF THE ACCESSORIES HOLDER

The accessories holder (16) allows you to fix the tube with the brush mounted on it on the body of the appliance.

To attach the hose to the appliance, slide the hook on the hose into the accessories holder slot on the appliance (Fig. 9).

CONNECTION OF ACCESSORIES

All the Lecoaspira accessory tools can be connected to the handle (A2) or to the extension tubes (D).

To connect accessories for suction and steaming (D-E-K-N) proceed as follows:

- connect the handle or the extension tube to the required accessory until the connector button (C) is hooked (Fig. A)
- to disconnect the accessory, just keep the connector button pressed (C) and separate the two parts (Fig. B)
- before using the accessories check they are fully connected.

To connect the accessories for suction only (F-M-Q-R-T) just push on, without hooking with connector button (C).

WARNING: in this situation, it is important not to press the steam button (A3), to avoid steam coming out accidentally.

SUCTION OF SOLIDS AND LIQUIDS

This appliance can be used to suck up dust or liquids equally easily.

However, if the water in the filter is very dirty it should be replaced proceeding as described in the section “Emptying and cleaning the Dirt container”.

When the dirt sucked in reaches the maximum permitted level in the Dirt container (20), suction is stopped automatically by the safety float provided for this purpose (you will notice that the engine speed has increased).

ATTENTION: switch off the appliance, and only switch on again after restoring the water level in the container as described in the “emptying and cleaning the Dirt container” paragraph.

IMMEDIATE RESTART WITHOUT RESTORING THE WATER LEVEL CAN DAMAGE THE AIR OUTLET FILTER.

Before resuming your cleaning operations, proceed as illustrated in the section “Emptying and cleaning the Dirt container”, and then top up the level of the water in the container.

BIOECOLOGICO

NB DO NOT USE BIOECOLOGICO OR OTHER PRODUCTS IN THE STEAM GENERATOR TANK, BUT ONLY IN THE DIRT CONTAINER (20).

To ensure the proper operation of the appliance during suction, Polti recommends using Bioecologico inside the dirt container (20).

Bioecologico is a natural deodorising, foam-free product that prevents foam build-up in the water filter to ensure proper operation of the appliance.

Bioecologico also acts as an effective deodorant when using the appliance because it is diluted in the dirt container before the appliance is switched on, and ingredients such as Tea Tree and L(+) lactic acid prevent bad odours from forming in the dirt container and release, instead, a clean scent into the air.

Use:

- shake the bottle before use and remove the lid
- hold the bottle upright and squeeze 5 ml into

the dispenser. Stop squeezing and pour the contents of the dispenser into the dirt container on the appliance;

- add water according to the instructions in the section “preparation for use”.

Bioecologico is available for sale in appliance shops and at authorised Technical Assistance Centres.

Bioecologico is available in pine or citrus scents.

EMPTYING AND CLEANING THE WATER CONTAINER

Switch off the appliance at the main switch (1) and disconnect the supply cable from the mains.

Lift the Dirt container (20) out of its compartment by the container handle (22) (Fig.3).

Turn the handle and take out the “EcoActive-Filter” water filter assembly (23), as in picture 4.

Empty the container tilting it towards the small groove (Fig. 10).

Pull the elbow tube (27) away from the net filter housing (26) until it is removed (Fig. 11a).

Take all the components apart and rinse them in running water. If the filter sponge has any tears, replace it. Filters etc are available as a kit, available by mail-order the Polti Service Centre.

A cleaning brush (20-A) is supplied for easy cleaning of the Dirt container (20); use it also to clean the appliance’s hose connections and the inside of tools.

NOTE: Do not use the brush for cleaning the outside of the appliance

If you wish to continue working, top up the level of the water. Put the “EcoActiveFilter” water filter assembly (23) back into the Dirt container (20).

ATTENTION: make the arrow on the elbow tube (27) coincide with the mark on the net filter housing (26) (Fig.11b). Put the Dirt container (20) back in its place as described in the “preparation for use” paragraph.

NOTE: make sure you empty the Dirt container (20) before putting your Vaporetto

Lecoaspira away. One of the great advantages of Vaporetto Lecoaspira is precisely the fact that it is possible to put it away clean.

How to clean the bucket:

As it is possible to suction up liquids, it is very easy to clean the bucket in your Lecoaspira.

When you have finished cleaning, empty the bucket as described and put it back in its housing in the machine.

Suction up about one and a half litres of clean water, turning on the suction for a few seconds. The whirlpool created inside the bucket will rinse the walls and dislodge any dirt. Clean water cleans the inside of the tubes as it passes through them. Now empty the bucket again and put the Vaporetto Lecoaspira away.

TIP FOR USING THE ACCESSORIES

DO NOT USE STEAM FUNCTION ON DRAYLON, VELVET, LEATHER OR OTHER SENSITIVE SURFACES.

If in doubt about the effect of steam on other surfaces, consult the manufacturer’s instructions and always proceed only after carrying out a test on a hidden part or a sample. Allow the area treated with steam to dry and then check whether any changes in colour or deformations have occurred before proceeding further, ensuring exactly the same steam power and distance as in the test.

When cleaning wooden surfaces (furniture, doors, etc.) and brick floors always proceed with caution since excessive use of steam could damage the wax, the polish or the colour of the surface to be cleaned. It is therefore advisable to apply the steam to these surfaces only for short periods at a time or to clean them with a cloth that has been treated with steam.

On particularly delicate surfaces (e.g. synthetic materials, enamelled surfaces, etc.) we strongly recommend using the steam at its lowest output power.

When cleaning glazed surfaces, if the

weather is particularly cold pre-heat the glass working at distance of about 50 cm away from the surface. To take care of your plants, we recommend spraying them from a distance of at least 50 cm.

UNIVERSAL BRUSH (E)

It is advisable to use this brush to clean large surfaces, tiled or marble covered floors, parquet, carpets etc., using the following inserts supplied with it.

- Bristle inserts (**E2**), for use when vacuuming only.
- Liquid suction inserts (**E3**), to pick up liquids; recommended for smooth surfaces.
- Fitted carpet inserts (**E4**), suitable for fitted and loose carpets.

The universal brush can be connected directly to the handle, or to the hose by means of the extension tubes (**D**).

ASSEMBLING INSERTS:

to change the inserts, slide out the insert from its position on the brush and slid in the replacement (Fig.C). When assembling the two inserts with bristles (**E2**), position the solid insert towards the BACK of the brush and the grooved insert towards the front.

When assembling the inserts for suctioning up liquids (**E3**), take care to ensure that their SMOOTH side faces inward.

120° STEAM-SUCTION ACCESSORY (K)

Use this accessory to clean areas that are difficult to reach with other accessories. The 120° accessory may be used for:

- treating stains on carpeting or loose carpets, before going over them with the brush;
- cleaning stainless steel, windows, mirrors, layered coating and paintwork;
- cleaning corners such as stairs, windows frames, door jambs, aluminium sections;
- cleaning the bases of taps;
- cleaning blinds, radiators, the interiors of cars;
- atomising house plants from a distance.

The 120° accessory can also be fitted directly onto the handle (**A2**) or it can be connected to the hose by means of the extension tubes (**D**).

It is possible to combine the 120° accessory with the following other accessories:

- **small coloured 120° brushes (L)**, suitable for removing caked dirt from very small surfaces such as cooking rings, shutters, between tiles, sanitary fittings and so on. The different colours mean that you can always keep the same small brush for use on the same type of surface.
- **The steam lance (K1) (OPTIONAL)** allows you to reach the most inaccessible places. Ideal for cleaning radiators, doorposts, sills, shutters and toilet bowls. To connect the lance to the 120° accessory screw it on the 120° accessory, as you screw the coloured brushes. The coloured brushes can be screwed on the lance itself.

SMALL STEAM-SUCTION UPHOLSTERY NOZZLE (N)

We suggest to use this accessory on large windows, large mirrors and smooth surfaces, or to clean upholstery surfaces such as sofas, mattresses, etc., using the following attachments supplied with it:

- **130 mm squeegee attachment (O) (OPTIONAL)**, for small windows;
- **200 mm squeegee attachment (O1)** for large windows and surfaces;
- **bristle attachment (P)** is recommended for carpeting, stairs, car interiors, and upholstered surfaces (AFTER TESTING FIRST ON A HIDDEN PART, WAITING AND SEEING HOW IT REACTS TO STEAM TREATMENT). It is also useful for removing animal hair from the same surfaces; a sponge cover (**E5**) may also be attached to the nozzle.

Fit the attachments and slide them onto the nozzle as shown in fig.D. To correctly use the steam-suction squeegee proceed as follows:

- apply steam uniformly to the surface to be

cleaned to dissolve the soiling.

- Press the rubber squeegee against the surface to be cleaned, moving it vertically from top to bottom with the suction function switched on. Warning: in particularly cold weather, pre-heat windows by applying steam from a distance of about 50 cm from the surface to be cleaned.

OPTIONAL ACCESSORIES

SMALL STEAM-SUCTION NOZZLE (M)

recommended for removing dirt from narrow surfaces such as the spaces between tiles, door jambs, shutters, etc.

UPHOLSTERY NOZZLE (Q)

recommended for cleaning fabric surfaces such as the seams in sofas, armchairs, mattresses.

NB DO NOT USE STEAM ON DRAYLON OR SIMILAR DELICATE SURFACES

SUCTION BRUSH (T)

recommended for dusting delicate surfaces such as frames, books, etc. using soft bristles.

LANCE (R)

recommended for deep cleaning of difficult spots such as skirting boards, folds in sofas, armchairs.

NB DO NOT USE STEAM ON DRAYLON OR SIMILAR DELICATE SURFACES.

Attach radiator brush (S) to the tip of the lance (R) to clean and remove accumulated dust, eg from gaps in radiators.

JOKER BRUSH (F)

With the Joker brush it is possible to remove all types of solid or liquid dirt, and it will work on any type of surface.

PARQUET ACCESSORY (G)

This accessory is for use solely with the Joker brush. Put the joker brush into place on the parquet accessory as illustrated in fig.12. Apply the brush to the accessory as indicated by the arrow so that the two pieces fit onto each other and then hook them to-





gether. To unhook the parquet accessory from the joker brush pull the two levers on the sides of the fitting outwards and then lift the brush off (Fig. 13).

USING THE IRON

Vaporetto Lecoaspira can be quickly transformed into a highly effective ironing system to make ironing quick and easy. Simply connect the product to the iron accessory for Vaporetto Lecoaspira (mod. PFEU0021). You may purchase the iron accessory at any Polti service centre or from top home appliance retailers.

- Connect the iron to the monobloc plug (B2) proceeding as shown in the "Operation" paragraph.

Check the manufacturer's label on the garment, and interpret the symbol on the label as follows:

	Steam ironing allowed For dry ironing, set thermostat on ...
	Steam ironing allowed For dry ironing, set thermostat on ..
	Check the fabric's resistance to steam ironing or dry iron with thermostat set on .
	- do not iron - steam ironing or treatment not allowed

- For STEAM ironing, turn the dial (Y) and set the iron temperature to its maximum travel on the "COTTON-LINEN" steam position.

NB YOU MUST SET AT ITS MAXIMUM POSITION, DO NOT SET AGAINST THE PICTURE OF THE IRON ON THE DIAL (Y).

Most types of fabric, other than delicates can be STEAM ironed at this temperature, please consult the garment manufacturer's instructions on the label.

NB fabric indications on dial are for DRY ironing, NOT steam ironing.

- Wait for a few minutes until the "Iron heating" indicator light (X1) goes out, to show that the soleplate of the iron has reached the required temperature.

- Press the steam request button (**X**) to enable the steam to come out. The steam flow will stop when the button is released. After each filling, when you first start to use the iron, a few drops of water mixed with the steam may be emitted (due to imperfect heat stabilisation). It is therefore advisable to direct the first jet of steam onto a rag.
- To obtain a continuous jet of steam move the sliding button (**W1**). The steam will continue to come out even when the steam request button (**X**) is released. To stop the flow of steam push the sliding button backwards (**W1**).

NOTE: using the iron, it is advisable to adjust the steam jet at medium output, or to do some testing in order to find the jet which is most suitable to the fabric to be ironed.

RECOMMENDED TECHNIQUE for steam ironing with the Polti iron is APPLY steam (button X) on the upstroke, then release button X (so no steam) for the backstroke, thus reclosing the fibres, preventing over-steaming and wetness.

- **ATTENTION:** if you iron sitting down, do not place your legs under the ironing board, the steam can cause burns.

GENERAL MAINTENANCE

Before carrying out any type of maintenance make sure that the power cable has been disconnected from the mains.

After using the brushes it is advisable to allow the bristles to cool in their natural position so as to avoid them getting deformed in any way.

Check the conditions of the gaskets located inside the monobloc plug (**B2**) periodically. If necessary, replace them with the appropriate spares. Also carry out the same check on the gaskets for connecting the extension tubes (**D**) and the handle (**A2**). To clean the outside of the appliance, just use a damp cloth. Do not use solvents or detergents as these might damage the plastic surface. To clean the "ECOACTIVE-FILTER" holder and clean or change the sponge filter, follow the instructions in the paragraph headed "EMPTING AND CLEANING THE Dirt container".

DRY IRONING

- If you need to DRY iron (ONLY) (NOT steam ironing), press the boiler switch (**2**) and adjust the temperature of the iron by turning dial (**Y**) to the temperature required for the fabric (as shown on the dial).

ATTENTION: when dry ironing, be careful not to press the steam request button (**X**), as hot water could come out of the iron onto your garment and board.

IMPORTANT NOTE

- Do not leave the iron unattended whilst connected to the mains.
- Iron only on heat resistant surfaces and on surfaces that allow the steam to escape e.g. **MESH** ironing boards.
- In case of accidental fall of the appliance it is necessary to have it checked by an authorized service center as the internal safety features may have been affected.

WASHABLE HEPA FILTER

WARNING: Vaporetto Lecoaspira is equipped with a washable filter. To clean the filter, proceed as follows:

- Unfasten the handle (22) of the Dirt container and remove the container (20) as described in the paragraph headed "PREPARATION FOR USE".
- Lift the Hepa filter release lever (18) and remove the filter from its recess (Fig. 14).
- Rinse the filter in cold running water. Shake it gently after washing to eliminate any residual dirt and excess water.

NOTE: let the filter dry naturally, far away from light and heat sources. You should wait 24 hours before reassembling the filter in the appliance.

- Replace the filter if it is torn (available as part of a filter kit by mail-order from Polti Service Centre)
- The filter should be cleaned every 4 months for average-frequency of use.
- To position the Hepa filter correctly (17) make sure that it fits properly into its recess (19) and then that the release lever

closes over it holding it in place (18) (Fig.14).

WARNING:

- Do not clean the filter with the brush, as this could damage it, decreasing its filtering capacity.
- Do not use detergents, do not scrape filter, and do not attempt to wash it in a dishwasher.

TROUBLESHOOTING

TROUBLE	CAUSE	SOLUTION
The suction fan does not start	No power supply	Check the cable, plug and socket
The suction power drops	The upholstery nozzle, the hose or the stiff suction tube are clogged. The Hepa filter is exhausted	Clean the filter and remove any obstruction from the tubes and accessories. Follow the instructions in the paragraph headed "GENERAL MAINTENANCE"
Water is spilled while sucking up liquids.	Float device clogged	Clean the "EcoActive Filter" water filter assembly.
The appliance has stopped vacuuming	The float device has interrupted suction	Switch the appliance off, make sure that water level in the tank is correct and switch the appliance back on.